

Design Parameters

Pleasurable Light Atmosphere
in Hospital Wards.



Herlev Hospital

Lone Stidsen

Phd Student at Aalborg University, Department of Civil Engineering

Textile Designer, Kolding Designschool

Projected partially financed by Philips Lighting

co writers:

Poul Henning Kirkegaard, AAU

Anna Marie Fisker, AAU

Marie Frier, AAU



Nakskov Hospital

- PROGRAM -

- Hospital design
- Atmosphere and design
- Light atmosphere in hospital wards, Design parameters user, space, light, time
- Perspectives



Herlev Hospital

The Hospital situation in DK



www.godtsygehosbyggeri.dk

GUIDELINES HOSPITAL DESIGN

Ulrich, R. & Zimring, C. 2004,
"The Role of the Physical Environment in the
Hospital of the 21st Century: A Once-in-a-Li-
fetime Opportunity"

Mullins, M. et al, 2009,
"Helende arkitektur"



Herlev Hospital

GUIDELINES HOSPITAL DESIGN

Dirckinck-Holmfeld, K., 2007.
"Sansernes Hospital"

Dalke, H., 2006.
"Colour and lighting in hospital design",

Foqué-Denkens-Adriaenssen, 1995,
"Designing for patients: a strategy for introducing human scale in hospital design",



Herlev Hospital

DANISH STANDARD 703

Direction for lighting in hospitals



ATMOSPHERE

Definition: Spheres of presence

Gernot Böhme



Salone del mobile: Tom Dixon

ATMOSPHERE

Atmospheres can not be seen. It must be experienced through other senses and an atmosphere occurs rarely through one sense alone, but in an interaction between several senses. Atmosphere affects people emotionally.

Niels Albertsen "Urban Atmosphere"



ATMOSPHERE

Is not a question of good taste.
It is everywhere and always present



View from my Studio, Aarhus

ATMOSPHERE

Is not a question of good taste.
It is everywhere and always present



Cafe in Lagos, Nigeria

ATMOSPHERE

Is not a question of good taste.
It is everywhere and always present



Peter Zumthor: The Therme Vals

ATMOSPHERE

Gernot Böhme: Atmosphere

From: Dalsgaard-Kortbak: Staging atmospheres in interaction design", Nordes (2008)

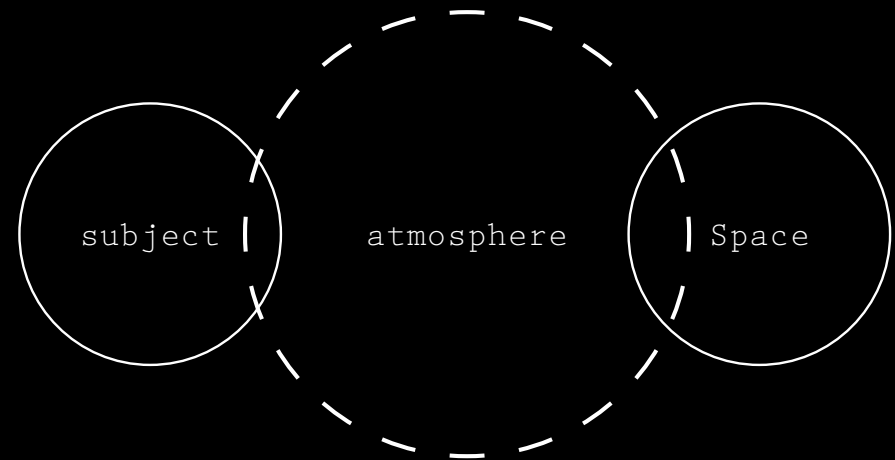



ATMOSPHERE

Dalsgaard-Kortbak: "Staging atmospheres in interaction design", Nordes (2008)

Social parameter

Technology

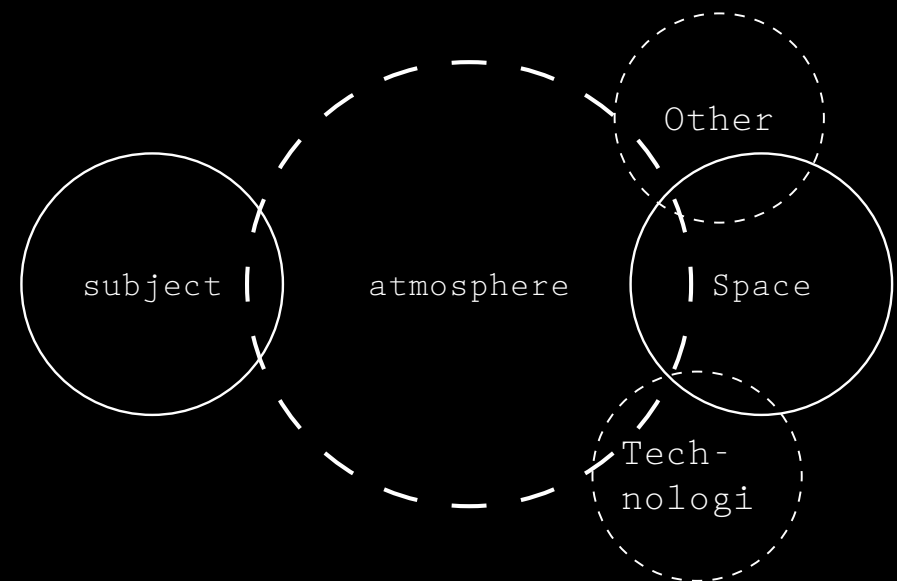

ATMOSPHERE

Our addition:

Time

Socio-cultural.

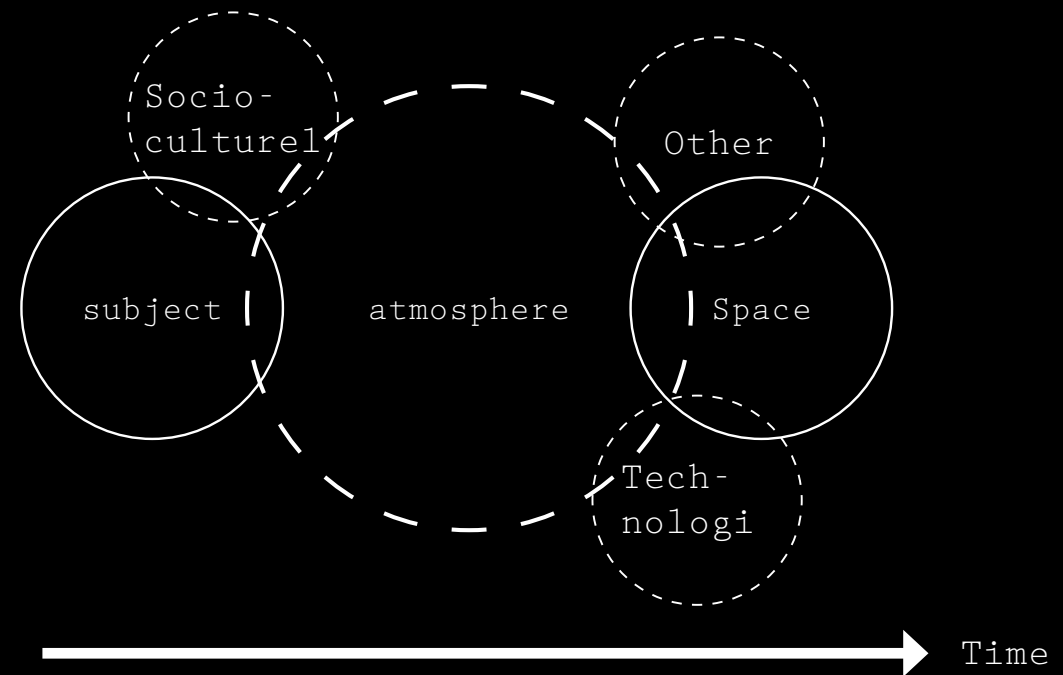

ATMOSPHERE

Different understandings
of atmosphere.

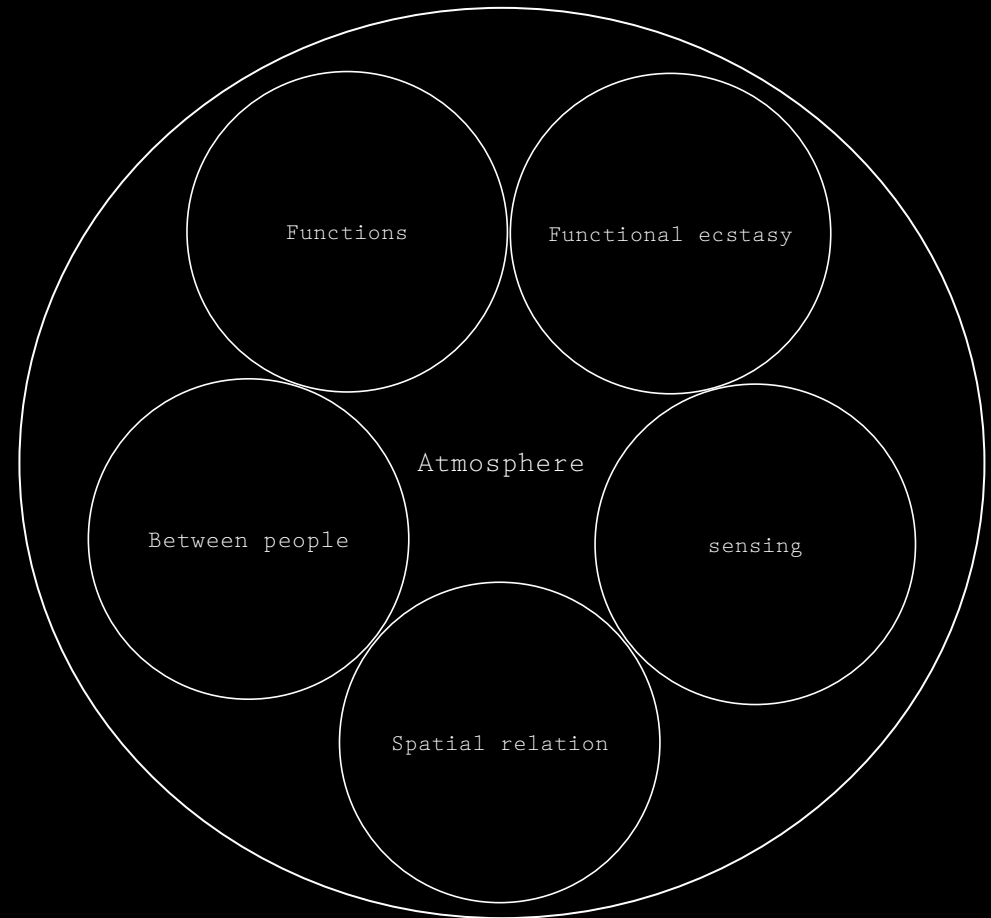

Design parameters

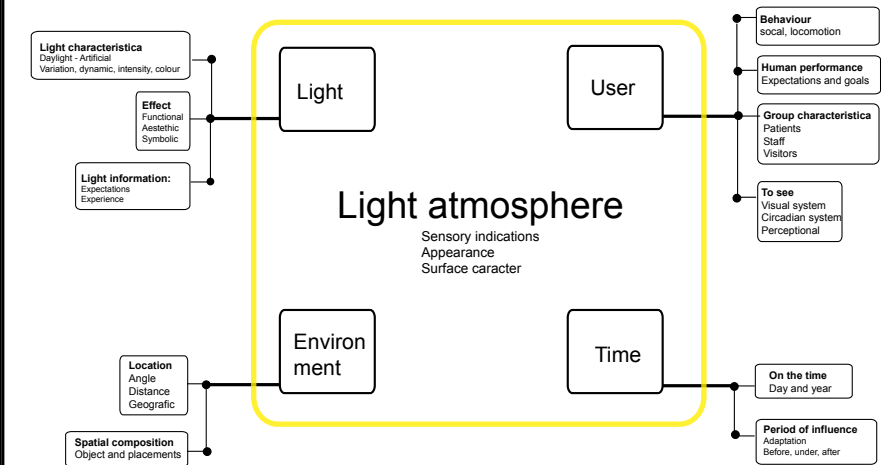

LIGHT

Characteristica

Effect

Information



LIGHT

Characteristica

Effect

Information



EFFEKT

Functional
Aesthetic
Symbolic



Boyce, PR. 2003, "Human factors in lighting"

EFFEKT

Functional
Aesthetic
Symbolic

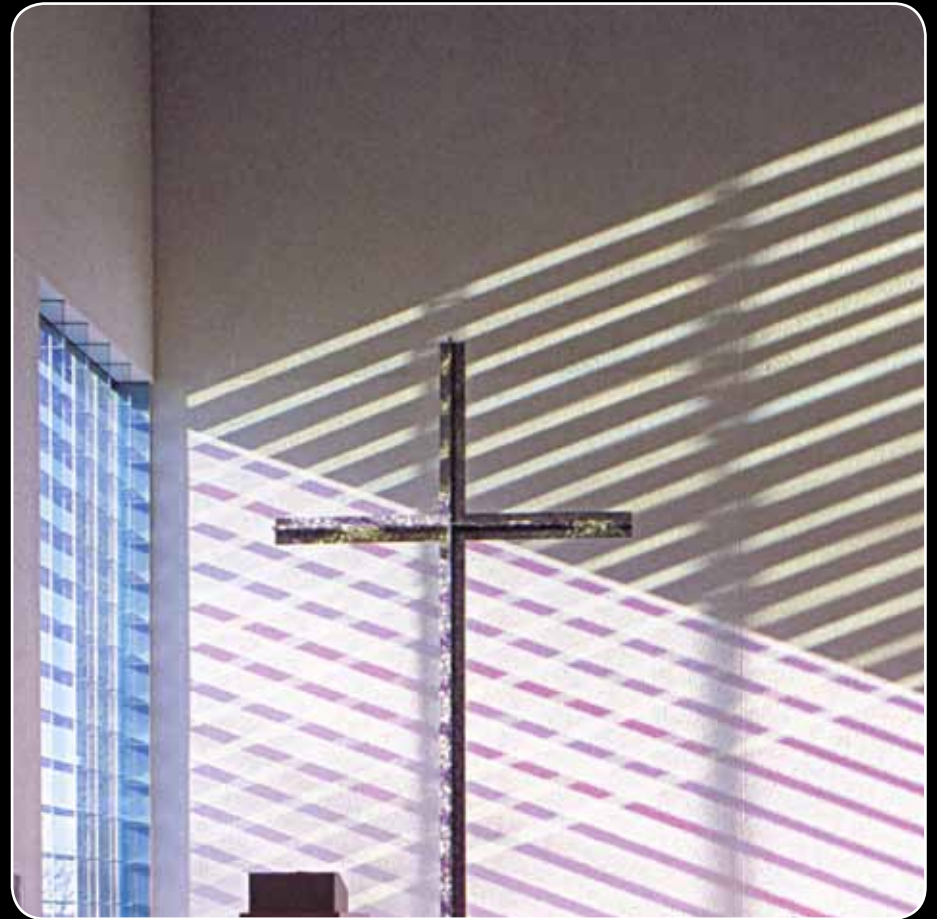

James Carpenter

EFFEKT

Functional
Aesthetic
Symbolic



Boyce, PR. 2003, "Human factors in lighting"

EXPECTATIONS & EXPERIENCE



EXPECTATIONS & EXPERIENCE



James Turrell (1999) *"The other Horizon"*

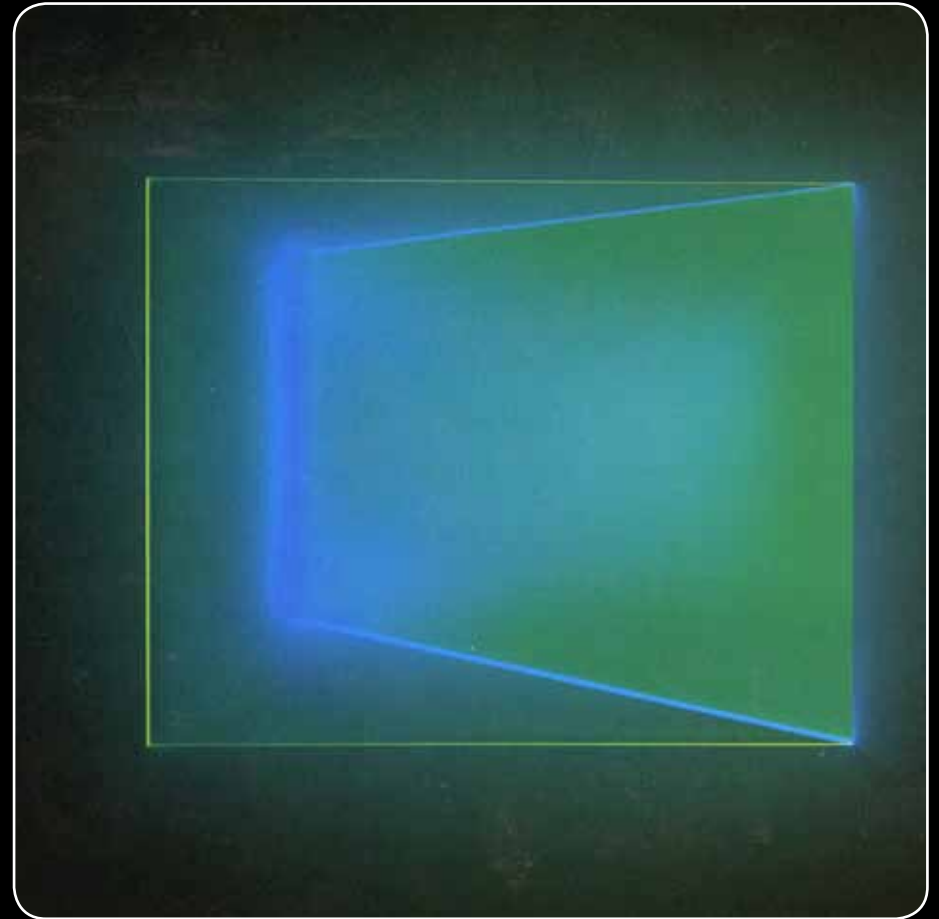

SPACE: LOCATION

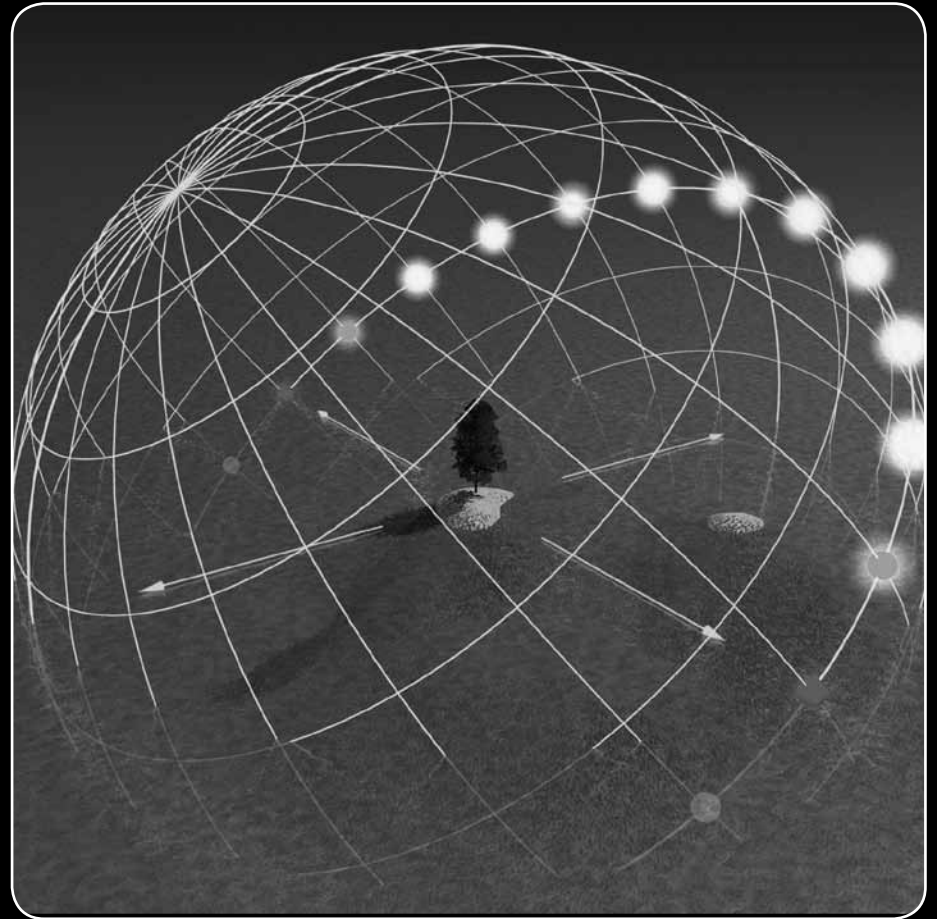

SPACE: LOCATION

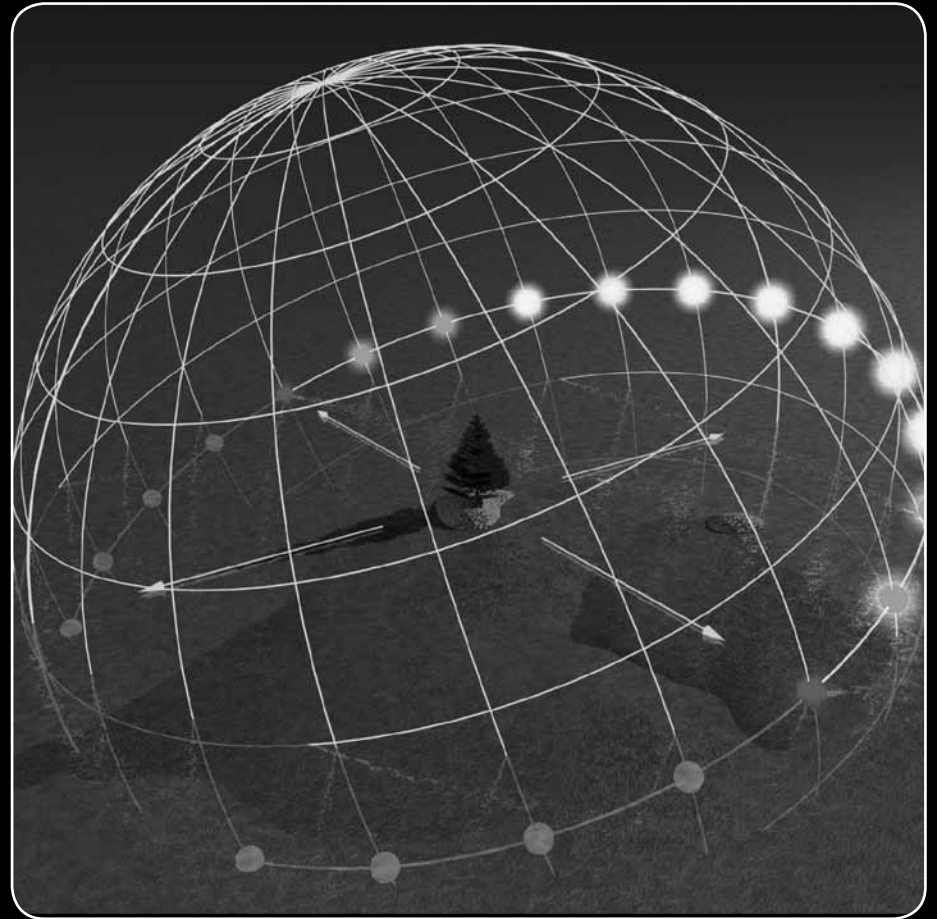

SPATIAL RELATIONS & OBJECTS



TIME

Year

Day



TIME
Year
Day



TIME

Year

Day



USER

groups
Biological
behaviour



USER

groups
Biological
behaviour



USER

groups

Biological

behaviour

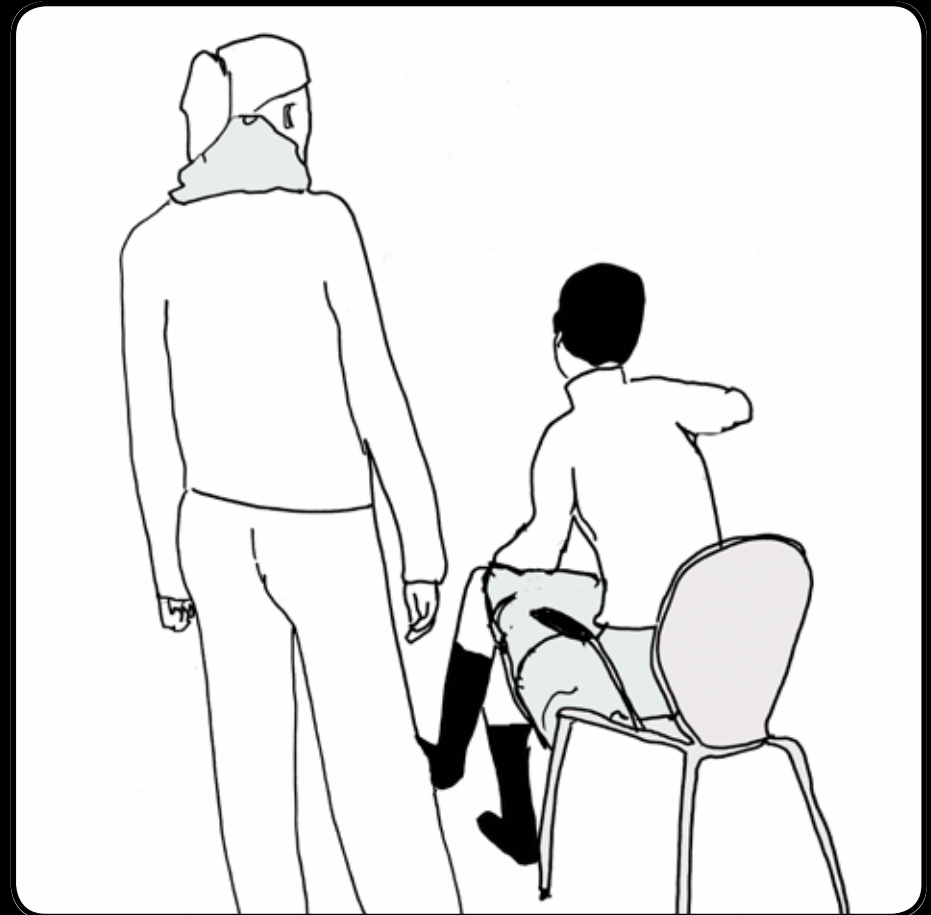

USER

Groups
Biological
Behaviour

The circadian system 97

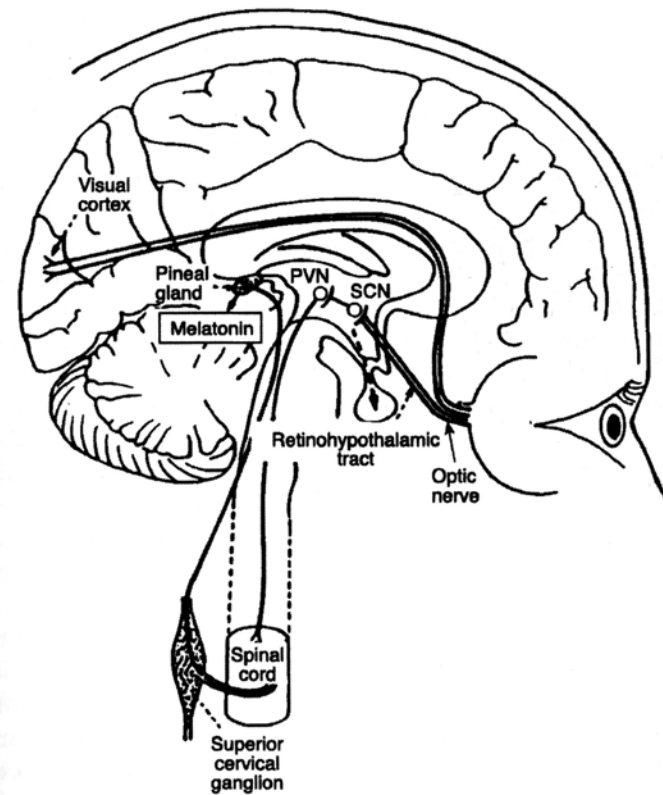

USER

groups
Biological
Behaviour

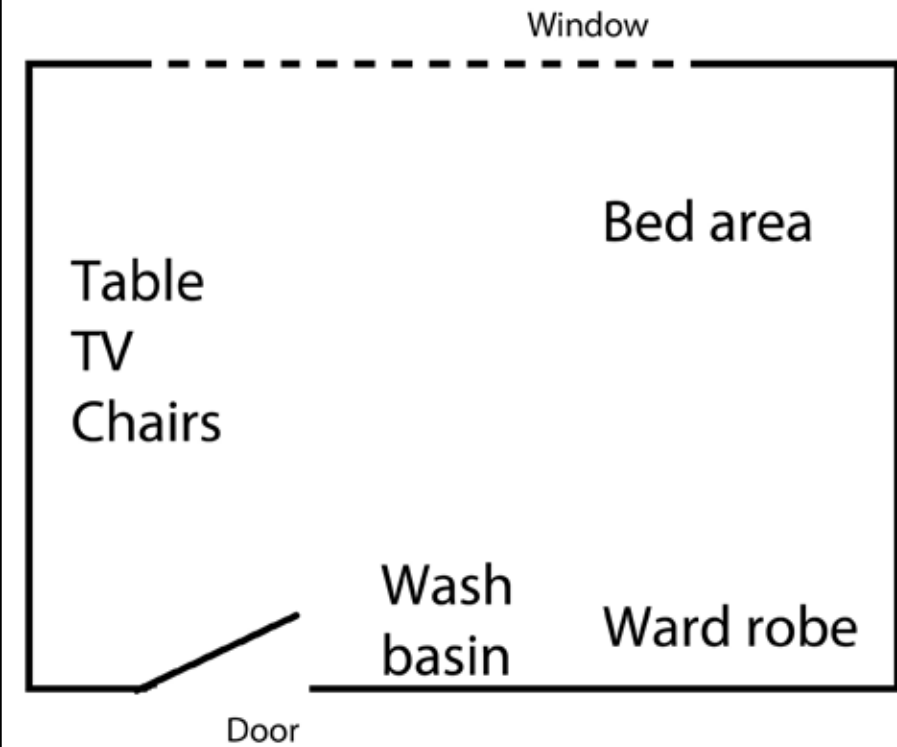

Design parameters

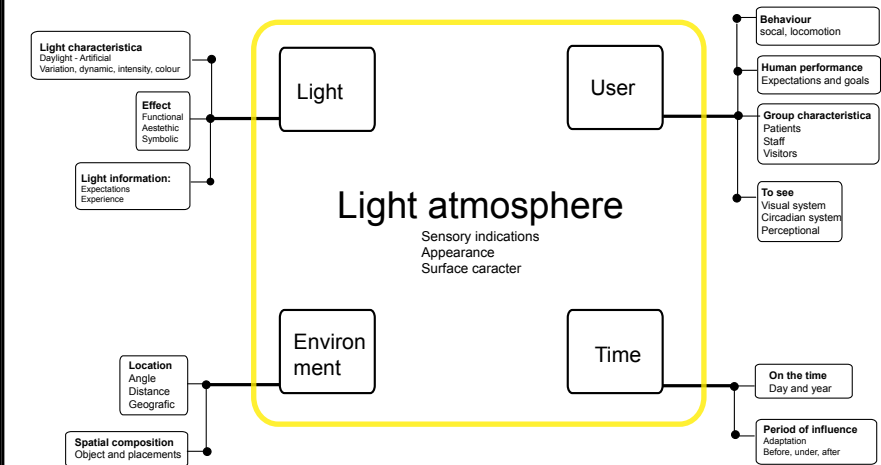

Acknowledgement:

Poul Henning Kirkegaard

Anna Marie Fisker

Marie Frier

Philips Lighting, Denmark



Complaints box from a hospital in Nigeria